

# USER GUIDE



# LandingZone

for 14-inch & 16-inch M1 MacBook Pro



For additional user guides, please visit [LandingZone.net/user-guides](https://LandingZone.net/user-guides)



## **Dear MacBook Pro Owner,**

Thank you for your purchase of the LandingZone Docking Station for the 14-inch and 16-inch M1 MacBook Pro. We hope the LandingZone will be an excellent addition to your workspace. This manual will help you through setup and answer any questions you may have.

If you have any questions or need support, please contact us at [support@landingzone.net](mailto:support@landingzone.net) or by calling 888-872-3251 during normal business hours.

Sincerely,  
LandingZone Team  
infiniWing, Inc.

## MODEL NUMBER

**LZ5014M** - LandingZone Docking Station for 14-inch M1 MacBook Pro

**LZ5016M** - LandingZone Docking Station for 16-inch M1 MacBook Pro

## COMPATIBILITY

The **LZ5014M** works with the 14-inch M1 MacBook Pro Model A2442 (Released 2021)

The **LZ5016M** works with the 16-inch M1 MacBook Pro Model A2485 (Released 2021)

## WHAT'S IN THE BOX?

- LandingZone Docking Station for 14-inch M1 MacBook Pro  
or
- LandingZone Docking Station for 16-inch M1 MacBook Pro
- 140W Power Adapter
- Quick Start Guide
- Warranty & Registration Card
- MacBook Port and MacBook Feet Protection Tape
- L-Shaped Audio Adapter

## BENEFITS

The LandingZone for 14-inch and 16-inch M1 MacBook Pro is our most advanced docking station to date. With an astounding 15 ports and connections, it is designed to transform the M1 MacBook Pro into a powerful and versatile workstation.

## FEATURES

- HDMI 1 Port (3840 x 2160 @ 30 Hz)  
or
- DisplayPort (3840 x 2160 @ 60 Hz)
- HDMI 2 Port (3840 x 2160 @ 30 Hz)
- HDMI 3 Port (3840 x 2160 @ 60 Hz)
- USB Type-C Passthrough Port  
(6016 x 3384 @ 60 Hz)
- USB 3.2 Gen 2 Type-C Port  
(Supports BC 1.2 Charging)
- 2 x USB 3.2 Gen 1 Type-C Ports
- 3 x USB 3.2 Gen 1 Type-A Ports  
(1 x Supports BC 1.2 Charging)
- Gigabit Ethernet Port
- Two-Way Audio Jack
- Kensington® Security Slot  
(Lock Sold Separately)
- Release Lever
- LED Indicator Light
- LandingZone Power Port  
(100W Power Delivery)

# DOCKING

## DOCKING

### Step 1: Connecting Power and Peripherals

- Connect the 140W LandingZone Power Adapter to the Power Port on the LandingZone.
- Connect Ethernet & peripherals such as monitors, keyboards, mice, storage devices, speakers, etc.

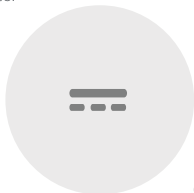

# DOCKING

## DOCKING

### Step 2: Docking Your MacBook Pro

- Place your MacBook Pro on the LandingZone and slide it back until the feet touch the rear guides on the LandingZone.
- Slide the MacBook to the left, connecting the Type-C ports on the MacBook Pro with the Type-C connectors on the LandingZone.

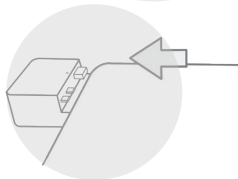

# DOCKING

## DOCKING

### Step 3: Connecting Your MacBook

- Push the right wing of the LandingZone into the ports on the MacBook Pro.
- Optional: Connect a Kensington Lock (not included) to the Kensington Lock Slot.





# UNDOCKING

## UNDOCKING

### Step 1: Ejecting Your Drives

- Safely eject all devices in the operating system of the MacBook Pro.



# UNDOCKING

## UNDOCKING

### Step 2: Disconnecting the Right Wing

- Grip the right wing of the LandingZone and pull it out of the MacBook.

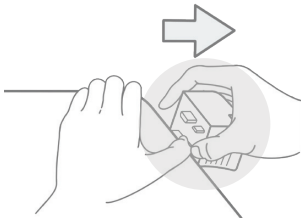

# UNDOCKING

## UNDOCKING

### Step 3: Disconnecting the Left Wing

- Press the release lever on the back of the left wing of the LandingZone to disconnect the MacBook.

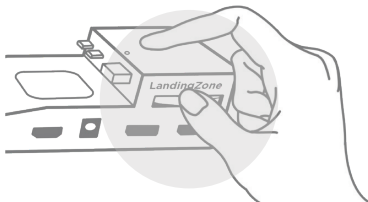

# UNDOCKING

## UNDOCKING

### Step 4: Removing Your MacBook

- Confirm that nothing is connected to the MacBook, then lift and remove the MacBook from the LandingZone.

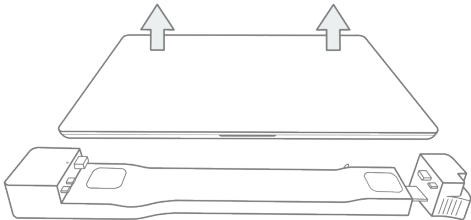

# CUSTOMER SUPPORT

## CUSTOMER SUPPORT

### **Online Support**

Go to [www.landingzone.net/FAQs](http://www.landingzone.net/FAQs)

### **Phone Support**

Call 1-888-872-3251 during normal business hours

### **E-mail Support**

Send email to [support@landingzone.net](mailto:support@landingzone.net)

## PROPER OPERATING ENVIRONMENT

**Operating temperature:** 50° to 95° F (10° to 35° C)

**Storage temperature:** -13° to 113° F (-24° to 45° C)

**Relative humidity:** 0% to 90% non-condensing

**Maximum operating altitude:** 10,000 feet

**Maximum storage altitude:** 15,000 feet

**Maximum shipping altitude:** 35,000 feet

## TROUBLESHOOTING / FAQs

### **USB Devices Are Not Working / MacBook is Not Charging:**

Make sure that both sides of the LandingZone are completely closed and flush against the MacBook Pro. Confirm that the LandingZone Power Adapter is properly plugged into your wall outlet and connected to the LandingZone.

### **How do you Reset the LandingZone?**

You can reset or power-cycle the LandingZone by undocking the MacBook Pro, disconnecting all connected devices and the LandingZone Power Adapter, and allowing the LandingZone to rest for a minute or two. After resting the LandingZone, reconnect the LandingZone Power Adapter, reconnect the devices, and dock the MacBook Pro to the LandingZone.

## CARE & CLEANING

Clean with a soft cloth. Do not use water or cleaning solutions to clean the LandingZone.

## DISPOSAL

Applicable laws may limit how you can dispose of this product. Accordingly, please make sure you follow your local, state, federal, and country ordinances, laws, regulations, and other guidelines to properly dispose of this product and the accompanying packaging materials.



# WARNINGS

## WARNINGS

- Do not dock to the LandingZone if a smartphone or tablet is already connected to the High-Powered Charging Port. Please disconnect any smartphone or tablet before docking and reconnect it after the MacBook has been docked.
- The DisplayPort on the LandingZone uses Type-C Alt Mode and some older DisplayPort Adapters may not be compatible with this new standard.
- The LandingZone is designed to work with the 20.5V power adapter included with the LandingZone. Using a different voltage power adapter may damage the LandingZone and MacBook.

## COPYRIGHT & TRADEMARK INFORMATION

© 2022 inifiniWing, Inc. LandingZone is a trademark of InifiniWing, Inc. Apple, the Apple logo, MacBook, macOS are trademarks of Apple, Inc., registered in the US and other countries. Kensington is a registered trademark of Kensington Computer Group, a division of ACCO Brands. HDMI and High-Definition Multimedia Interface are trademarks or registered trademarks of HDMI Licensing LLC. All other company and product names mentioned may be trademarks of their respective companies. Mention of third-party products is for informational purposes only and does not constitute an endorsement or recommendation. inifiniWing, Inc. assumes no responsibility with regard to the performance of products mentioned.

Designed in San Jose, CA & manufactured in China. Protected by **US Patent #9,651,994** and foreign patents.

